

Curved Access Door for Circular Ducts

AD-ADC



Description

Double Skinned Insulated Access Doors come complete with punched holes in front and back flanges for easy installation in plain or insulated ducting. They are available in a variety of sizes ranging from 200mm x 125mm up to 635mm x 430mm.

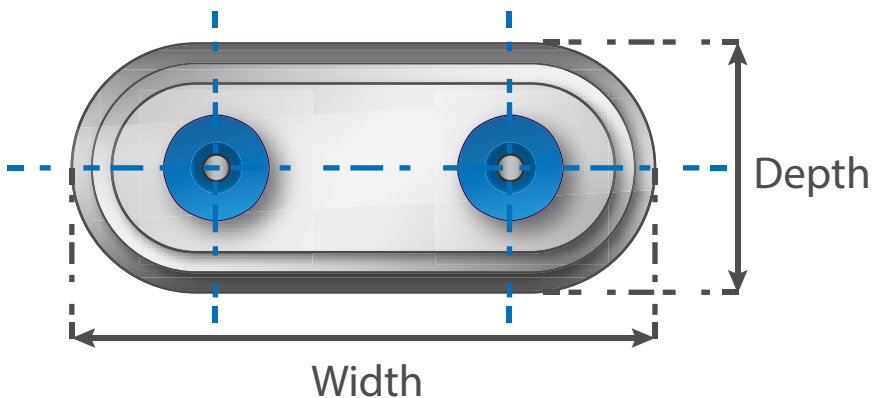

Dimensions

WIDTH x HEIGHT x DIAMETER(mm)
180 x 180 x 80
180 x 180 x 100
180 x 180 x 125
250 x 150 x 150
250 x 150 x 160
250 x 150 x 180
250 x 150 x 200
250 x 150 x 224
250 x 150 x 250
250 x 150 x 280
250 x 150 x 315
250 x 150 x 355
250 x 150 x 400
250 x 150 x 450
400 x 300 x 400
400 x 300 x 450
400 x 300 x 500
400 x 300 x 560
400 x 300 x 630
400 x 300 x 710
400 x 300 x 800
400 x 300 x 900
400 x 300 x 1000
400 x 300 x 1120
400 x 300 x 1250

Material & Finish

Material: Galvanised Steel

Colour: Silver

Please contact Glovers sales department for more information.